

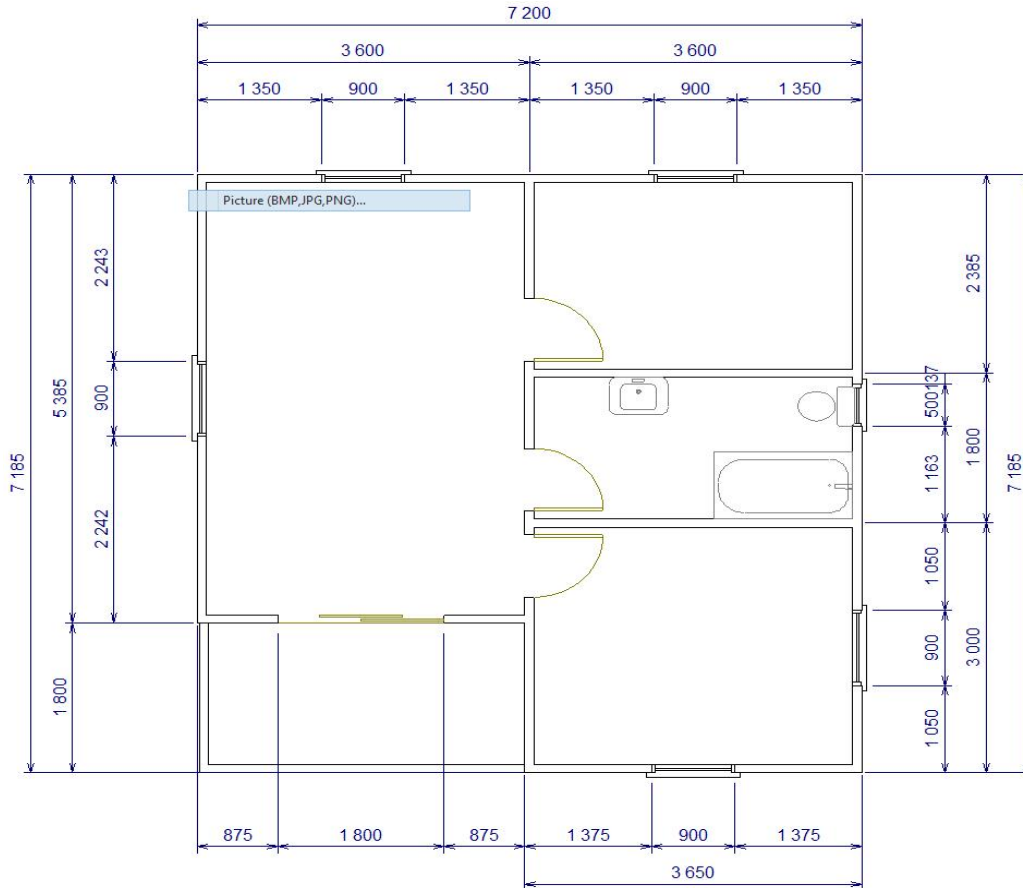

Cosy Cabins
YOUR WORLD IN WOOD

72 Ouklipmuur avenue
Willow Park Manor
Fax: 086 6485138
info@cosycabins.co.za
www.cosycabins.co.za

Tel no: 073 0687653
Tel no: 082 8820717
Tel no: 08 17071452



7.2mx7.2m Bushveld Cabin (Example of a Layout)

New Normal Shell Price: R 104 530,00 (This layout is not fixed and Clients can ask us to change the layout)

Shell Price Spring Special: R 78 399,00 Shell price includes the following:

25% discount

- 1: All windows as per floor plan pine glazed, (0.8mx0.9m), and (0.8mx0.45m)
- 2: 1.8mx2.1m pine sliding door, glazed no lock included.
- 3: All timber frames for partitions build, all internal hollow core doors hung only.
- 4: The stilted base of Approx 0.5m and steps are included.
- 5: Corrugated iron roof with Insulation in roof, if ceiling is installed Sisalation will be changed to 40mm Polytherm in the ceiling, **at no charge**.

NB. Please Inquire for any additional services not listed.

Select from the following optional features to suit your personal preferences:

1: Double Walls:	R18 335.00	Windows:	ND1	R400.00 (0.8mx0.45m)
2: Flat Ceiling:	R13 600.00		ND2	R500.00 (0.8mx0.9m)
3: Bathroom:	R8 800.00	(Bath, toilet, bain)	ND3	R895.00 (0.8mx1.30m)
4: Geyser	R4 295.00		ND54	R1 495.00 (1.50mx1.50m)
5: Chromadeck:	R7 092.00			
6: 40mm pollytherm	R7 948.00	(outer walls only)		

All windows are glazed pine windows, these windows can be upgraded to, Meranti window frames, or Alluminium. Prices can be requested.

- 7: Electrical price quoted per client specs and request
- 8: Delivery cost will be calculated per client request

9: Anything on the unit can be adapted to suit our clients, please ask if this is needed.

10: Units Can be build according to SANS 10082 as the units are timber frames, we will require approved plans.

11: Services such as a Fire consultant and fire treatments supplied by him are also available, if required by a coucil.

12: Additional timber treatments are also available should they be required.